



Welcome to Tiverton Museum of Mid Devon Life!

Accessible map and information

This guide has been prepared to help you find your way around the museum as easily as possible, and to inform you of the facilities that we can provide.

All of our staff and volunteers wear name badges and will be happy to assist you to ensure your visit is as enjoyable as possible.

We welcome any feedback on how we can improve our services.

Contents:

Visitor information	Pages 2-3
Resources	Pages 3-4
Floor-by-floor access guide	Pages 4-5
Floor maps & access guide	Pages 6-8

Visitor information

Opening hours

Tiverton Museum open Monday to Friday, 10.30 to 4:30 and Saturdays 10:00 to 4:00.

The museum is closed Christmas and January.

The Tourist Information Service has different opening hours to the museum, please ask at the Front Desk for details.

Information

If you have any questions or need help at any time, please speak to a member of staff at the Front Desk.

Assistance dogs

Guide dogs, hearing dogs and assistance dogs are welcome throughout the Museum. Please ask for water/food bowls which can be borrowed from the Front Desk.

Lifts

The lift is wheelchair accessible.

Toilets and baby changing facilities

All toilets are by the entrance on the Ground Floor, including a wheelchair-accessible toilet. Baby change is available in the ladies and gentlemen's toilets.

Breast feeding

The Museum welcomes breast feeding. If you require a private space, please ask the Front Desk and access will be provided to a quiet office area whenever possible.

First aid

If you require first aid please alert the Front Desk staff. 2

Picnic areas and refreshments

In good weather packed lunches can be eaten in the yard area of the museum. The museum does not have a café, but there are a number of independent cafes nearby, please ask the front desk for details. Your ticket is valid for the whole day and you can come and go from the museum as you like.

Keep in touch

For general enquiries contact us on **01884 256295**. To be the first to hear about our upcoming events, exhibitions and family activities please sign up to our e-newsletter by emailing **curator04@tivertonmuseum.org.uk**

Become a member

Enjoy free admission to the museum and discounts off some of our events. To find out more please ask at the front desk or see **<http://www.tivertonmuseum.org.uk/fp.php?id=663>**

Resources

Wheelchairs

the Museum is fully wheelchair accessible. A wheelchair is available and can be booked in advance by telephoning 01884 256295 or borrowed on the day by asking a member of staff at the front desk.

Induction loop

A portable induction loop is available on the Front Desk on request.

Magnifying glasses are available from the Front Desk

Large print introductory text for each gallery is available in large print format near the front desk.

Hands-on

The museum has many items on open display which can be touched gently by visitors with sensory impairments. Please be careful of the ploughs in the yard which are not suitable for touching.

The museum offers regular themes object handling sessions in the galleries in school holidays. Please look at our current 'What's On' guide or on the website for details.

Sighted Guiding

Some staff and volunteers are trained in Sighted Guiding. Staff are able to offer assistance in the reception, shop and Tourist Information areas.

For a Sighted Guided tour of the museum (on a one to one basis) please call 01884 256295 to discuss booking.

Floor-by-floor access guide

Tiverton Museum has two floors with two sets of stairs and a lift. This guide highlights the physical accessibility of all floors.

The floors have carpet tiles throughout with a low pile (apart from the Kitchen/Laundry Gallery which has a lino floor). The galleries across the Yard have alternative floor coverings which are detailed below.

Ground floor

The Main Entrance provides level access to the Museum. The reception area, shop and Tourist Information are all on the same level as the entrance.

There is a shallow ramp down to the ground floor galleries which is marked on the floor.

(If you are attending an event in the Education Room it is located on the ground floor and there is a small ramp upwards into the room).

First Floor

The First Floor can be accessed by a set of stairs from the Agricultural Gallery which has 14 steps and a further 2.

There are some shallow ramps on the First Floor: from the Merchants House up into the Archaeology Gallery, and down out of Archaeology Gallery; down from the Kitchen/Laundry Gallery to the Upper Amory Gallery.

The Ground Floor is accessed by a wooden staircase with 18 steps.

There are some rope barriers to direct visitors around the First Floor, please feel free to move them to access the lift.

The Yard, Alford and Authors Galleries

The Yard has a tarmac finish which is a little uneven in places. The easiest route for wheelchair users to access the Yard is through the shop rather than through the Lower Amory Gallery.

The Alford Gallery has level access with a concrete floor. The Authors Gallery is accessed through glass double doors (for assistance please ask at the Front Desk). There is level access with a lino and wooden floor. There is a shallow ramp upwards to access the far side of the gallery, or a set of 5 steps. There is no wheelchair access into the cab of the Tivvy Bumper engine.

GROUND FLOOR

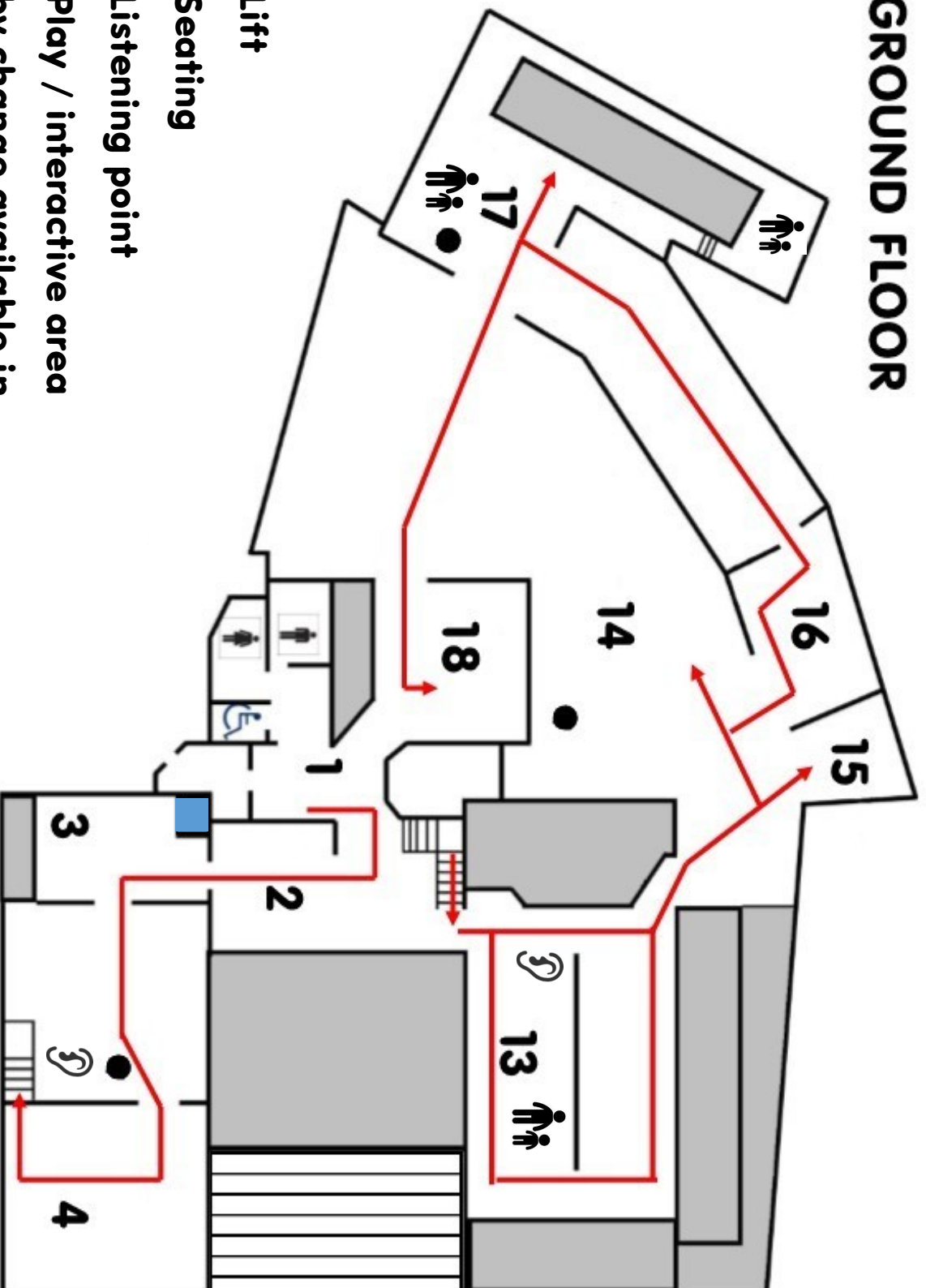

■ Lift

● Seating

👂 Listening point

👶 Play / interactive area

👶 Baby change available in ladies and gentlemen's toilets

First Floor

Emergency
wheelchair
refuge area

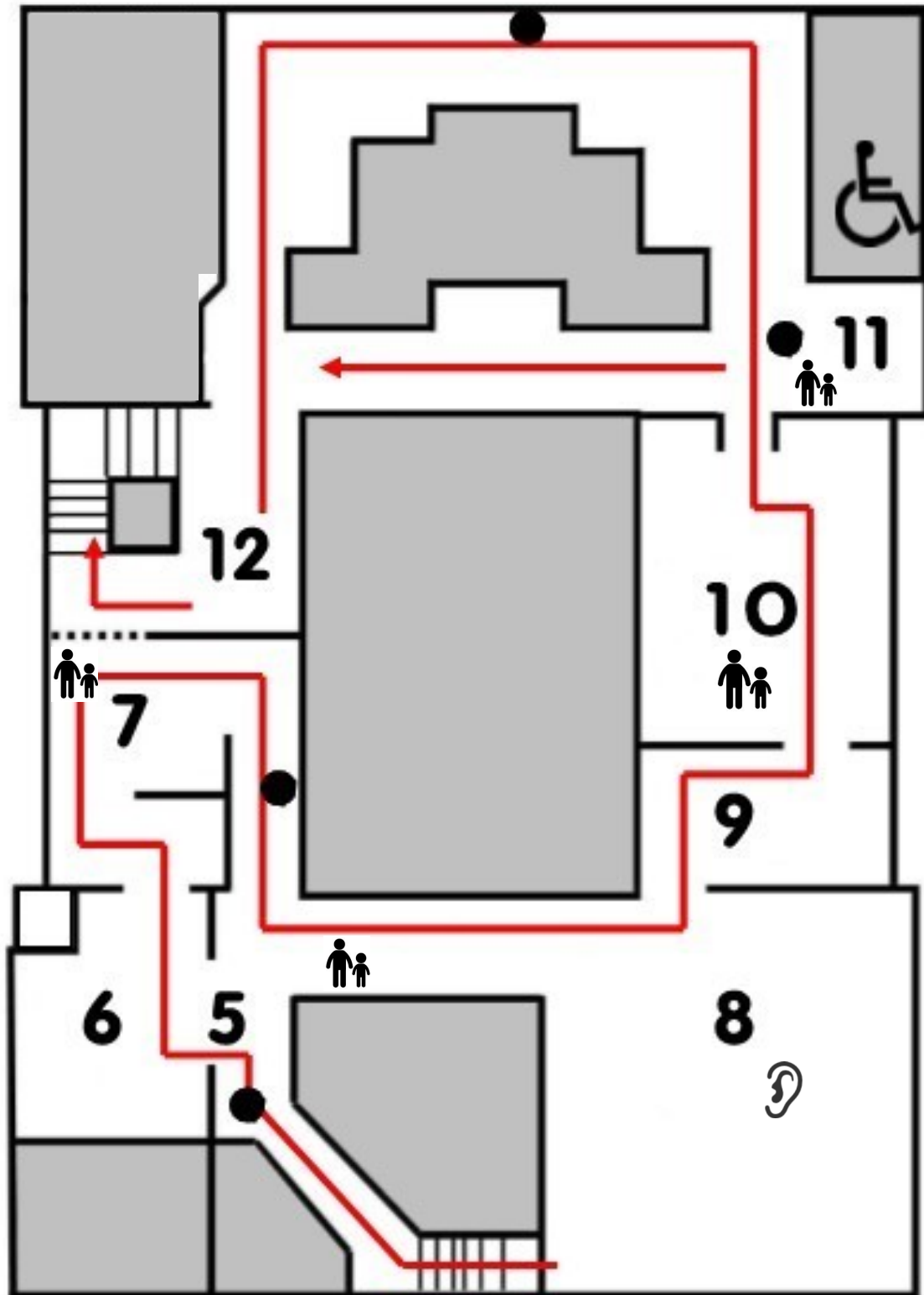

FINDING YOUR WAY AROUND THE MUSEUM

RECOMMENDED ROUTE

1. RECEPTION
2. TEMPORARY EXHIBITION GALLERY
3. DICKEN GALLERY
Mid Devon Today
4. AGRICULTURAL HALL
Farming, milling, cider making and poaching
5. UPPER AGRICULTURAL HALL
Sheep farming and the wool trade
6. MERCHANT'S HOUSE
Wool Merchant's House around 1600
7. BRITTON GALLERY
Local archaeology
8. HEATHCOAT GALLERY
Lace making factory
9. COTTAGE PARLOUR
Victorian scene
10. KITCHEN AND LAUNDRY GALLERY
Cooking and laundry equipment from the past 150 years
11. UPPER AMORY GALLERY
Local trades and industry, public health and civic life
12. BRITTON GALLERY
Local architecture and building materials
13. LOWER AMORY GALLERY
Mid Devon at war, leisure time, toys, schools, shops and costume
14. COURTYARD
Agricultural implements
15. BROOMFIELD GALLERY
Silverton Fire Engine
16. ALFORD GALLERY
Farm carts and waggons, wheelwrights and blacksmiths
17. AUTHERS GALLERY
Transport on roads, railways and the canal, including the 'Tivvy Bumper' engine
18. SHOP