

Cribbs Patchway Metrobus Extension

SGC officer presentation
SusCom meeting - 27 November 2018, Aviva

Transport improvements & development

- A range of transport initiatives are planned for and under construction to help alleviate congestion and mitigate impacts of forthcoming development:
 - Horizon 38 – 1 million square feet
 - Cribbs Patchway New Neighbourhood – 5700 dwellings, 50ha employment, other uses
 - Harry Stoke & East of Harry Stoke – 3000 dwellings
 - Severnside
- Metrobus is a major component of the transport vision for the area, together with rail, park and ride, junction improvements, local bus service improvements, new roads, cycling and walking...

Metrobus

- Limited stop.
 - Buy before you board.
 - Twin doors.
 - Fast and reliable journey times.
 - High quality and environmentally friendly vehicles.
-
- Services launched on two routes, a third launching in early 2019.
 - Already proving popular, with patronage being higher than forecast.



Metrobus network

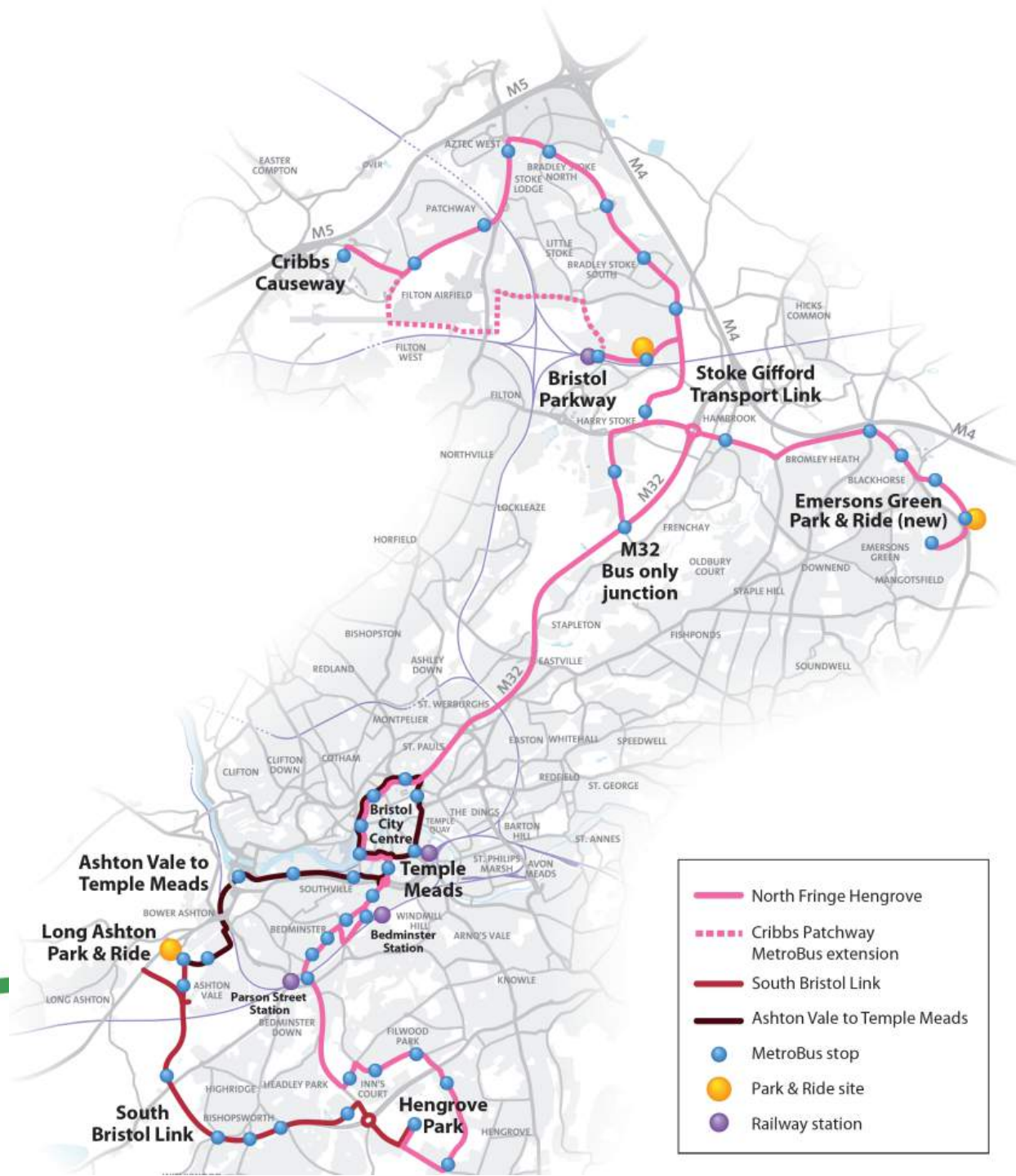

Planning applications

- Four separate planning applications for different sections of the CPME scheme were submitted in February:
 - San Andreas roundabout PT18/0992/R3F
 - North Way bus link PT18/0988/R3F
 - Gipsy Patch Lane railway bridge PT18/0986/F
 - Gipsy Patch Lane highway works to east and west of the bridge & Hatchet Road bus stops PT18/0987/R3F
- Planning permission has been granted except for North Way – the Environment Agency has raised an objection on flooding grounds so we are exploring alternative options.

Gipsy Patch Lane railway bridge

- Significant element of the CPME scheme; a once in a lifetime opportunity
- Designed and constructed by Network Rail
- Substantial benefits for all highway users when complete:
 - shared use paths on both sides
 - bus lanes in both directions
 - general traffic lane in both directions
 - height restriction removed
- ...pinch point gone
- Planned replacement Easter 2020



Current Gypsy Patch Lane bridge





Indicative programme

- Widespread ongoing communications begins early 2019
- Mobilisation and construction commences summer 2019
- Gipsy Patch Lane bridge 'landed' Easter 2020
- Scheme complete and Metrobuses running on route 2022.

Traffic management on Gipsy Patch Lane

- Works east and west of bridge will require either a closure in one direction or temporary traffic lights.
- Anticipated full closure for approximately eight months in 2020 at the bridge.
 - Access to side roads and businesses off Gipsy Patch Lane maintained
 - Diversion routes in place
 - Likely to be a shuttle bus service for pedestrians
- Vehicle diversion routes will be planned in advance and well signed. This will include diverting as much through traffic as possible away from the area.

Our commitments

- Use of best practice examples e.g. Bromley Heath viaduct works in planning for, undertaking and communicating the works.
- Wide range of communication and engagement activities.
- We will work with local people and businesses to minimise impacts.
- We will review the construction programme on an ongoing basis to take any opportunities to shorten the duration of works.
- Construction, Environmental and Traffic Management Plans.

Questions?

www.southglos.gov.uk



Site layout plan for railway bridge

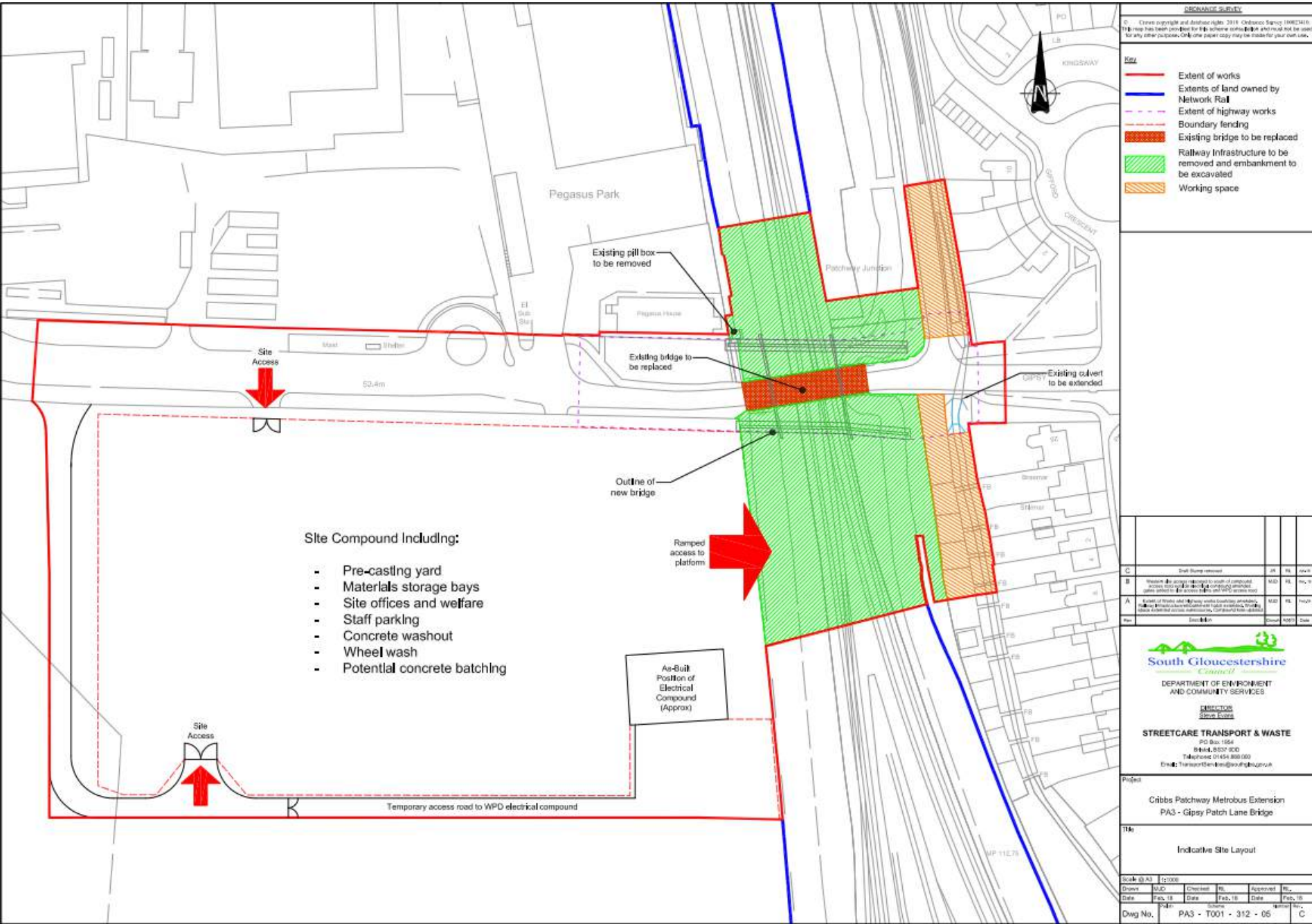

C	Drill Bore removal	18	18	18	18
B	Pre-cast concrete elements to be cast in situ and placed in position for concrete pump to be used to place concrete in the formwork and to be removed	18	18	18	18
A	Extent of works shall be in accordance with the contract documents and shall be subject to the contract documents and shall be subject to the contract documents	18	18	18	18
Rev	Issue	Drawn	Checked	Approved	Date

South Gloucestershire Council
 DEPARTMENT OF ENVIRONMENT AND COMMUNITY SERVICES
 DIRECTOR
 Steve Lewis
STREETCARE TRANSPORT & WASTE
 PO Box 1564
 Bristol, BS20 9DD
 Telephone 01454 800 000
 Email: Transport@stg.westgovernance.gov.uk

Project
 Cribbs Patchway Metrobus Extension
 PA3 - Gipsy Patch Lane Bridge

TA
 Indicative Site Layout

Scale	1:1000
Drawn	MJD
Checked	RL
Approved	RL
Date	Feb. 18
Date	Feb. 18
Date	Feb. 18
Date	Feb. 18
Dwg No.	PA3 - T001 - 312 - 05
Sheet No.	C